

## EXITGUARD EX104-30, EX105-30 and EX106-30 Extended DOTL delay

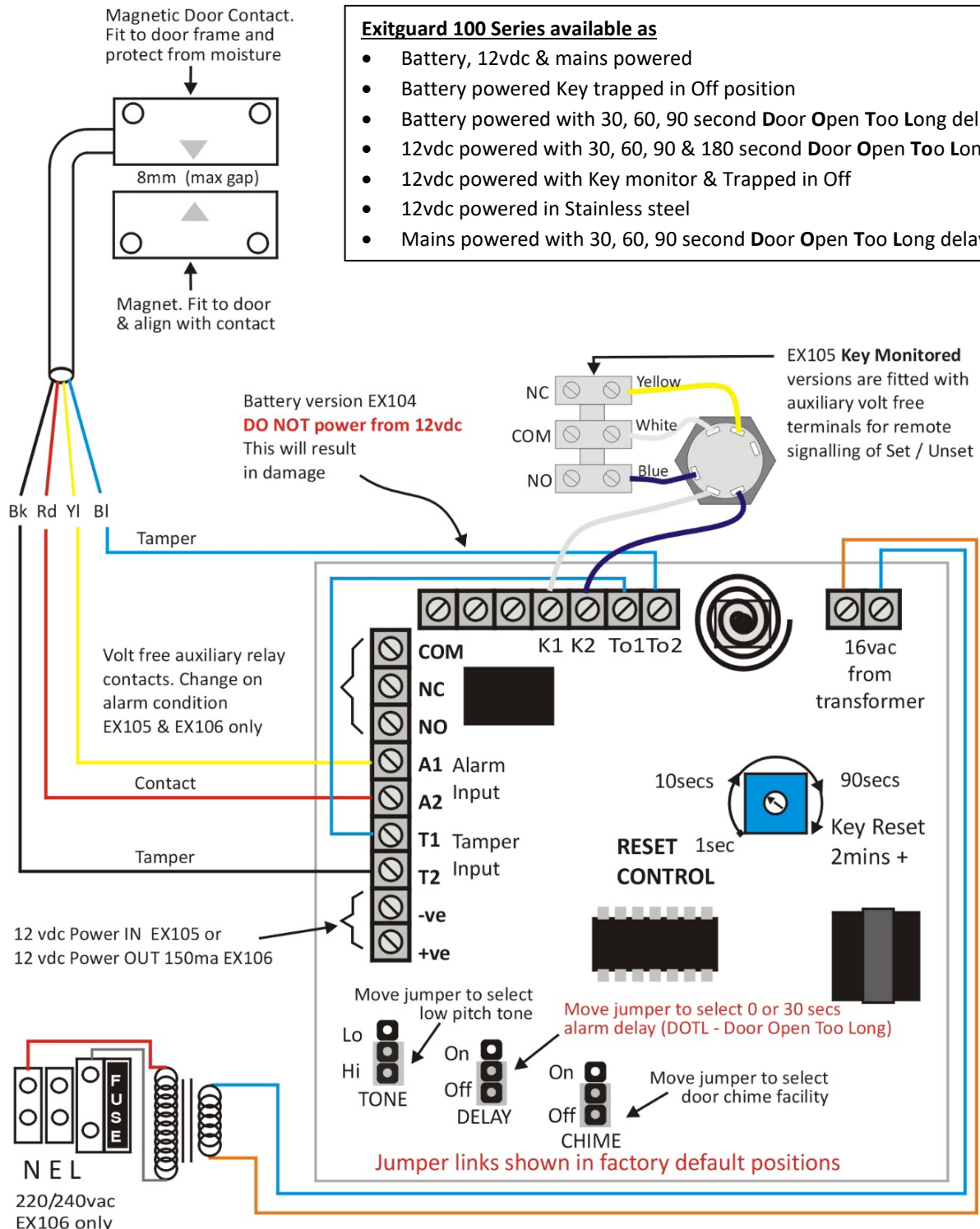

The EX100 series provides a simple to operate solution for 24 hour protection of fire exits and other doors. A number of options are available that can be set up at the installation stage.

Basic Chime repeating at 15 sec intervals [1]	30 sec Delay before alarm without pre-warning [5]	Tamper omit if T1 & T2 linked	Double bleep for set, single bleep for un-set
Auto Reset adjustable 1 sec to 90 secs [2]	30 sec Delay before alarm with pre-warning [6]	Battery fault test when the key is used & at 5 mins intervals	Pass through / safe set facility
Keyswitch Reset [3]	Low level tamper once acknowledged every 5 mins	Hi & Lo level alarm tones	Isolate alarm by turning Keyswitch to off position
Instant Alarm [4]	Reduced alarm after 2 minutes if not reset	LED status indicator	Auxiliary relay available for remote signalling

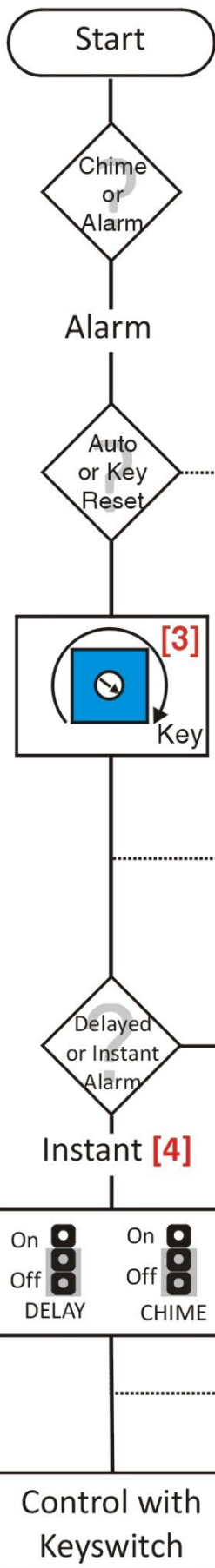



Tone Select does not affect any other programming

Lo   
 Hi   
 TONE

Chime [1]

Basic CHIME facility repeats at 15 second intervals

Auto Reset time can be adjusted between 1 and 90 seconds  
 Beyond 90 seconds it becomes Key Reset

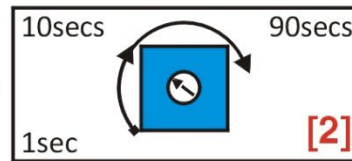

Auto reset

Turn pot fully clockwise to invoke Key Reset ie Factory default

The exact position for maximum reset time (90 secs) is approximately 2 o'clock.  
 To determine this position exactly, ensure that the door contact and the tamper loop are both open.

The keyswitch should be in the O (Off) position.

Apply power and switch to the I (On) position.

Within 3 seconds the sounder will give a bleep followed by four rapid bleeps.

Turn the potentiometer anti-clockwise slowly and observe:

- At Key Reset a Chime & no LED [3]
- At Max Reset a Barp & no Led [2]
- Below Max Reset Silence and steady LED

Delayed



Yes

No

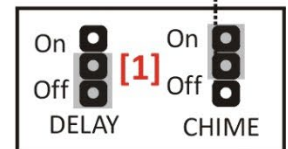
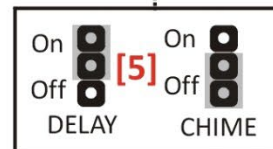
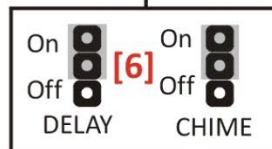
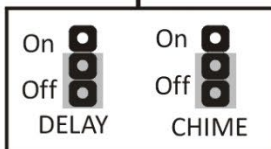

Set jumpers for desired operation

**Note:** There are no programming options for tamper facilities.